



Technical Data Sheet

M12 (L)

» Oil service

M12 (L) VE

» Water service

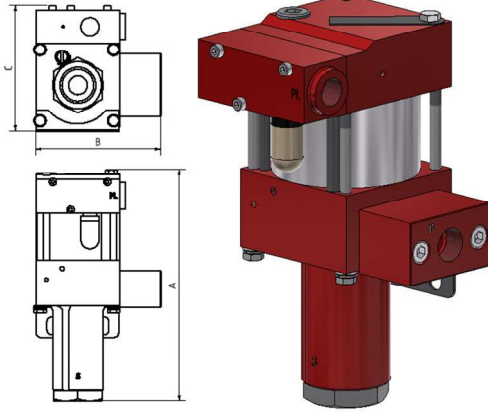

M12 (L)
single acting, single air drive head
(Standard= Bottom inlet)

Technical Data:

Air drive pressure:	1 - 10 bar / 14.5 - 145 psi
Calculated working pressure:	140 bar / 2030 psi
Pressure ratio:	1:14
Displacement volume/double stroke:	9.4 cm ³ / 0.57 cu.inch

Connections:

Inlet:	Standard: Bottom Inlet 3/4" BSP
Outlet:	1/2" BSP
Air drive:	3/8" BSP
Maximum operating temperature:	60°C
Net weight:	3.0 kg

Pressure and flow performances, please see enclosed graph.

Wetted materials of construction:

Seal package:	M12(L): Polyurethane, NBR M12(L)VE: UHMWPE, FKM
Pump Body:	3.1645
Piston:	1.4112
Fittings:	Inlet: 1.4305 Outlet: 3.1645

Approximate Dimensions:

A:	214 mm
B:	119 mm
C:	120 mm

Available Options:

Seal material for oil service:	M12(L)
Seal material for water service:	M12(L)VE
Special inlet and outlet ports, i.e. NPT:	M12(L)-NPT M12(L)VE-NPT
Special seal material to handle special fluids on request.	

Available Accessories:

Air control units for M series with filter pressure regulator, control pressure gauge and shut off valve: M12(L) with C1

To protect the pump against excessive outlet pressures or to limit the outlet pressure, a safety valve M12(L) with C1/SV-air (The required outlet pressure has to be indicated.) can be fitted to the air control unit in the air drive line.

Please consult factory for more information. All technical and dimensional information subject to change. All General Terms and Conditions of sale, including limitations of our liability, apply to all products and services sold.

Technical Data Sheet

MO12

» Oil service

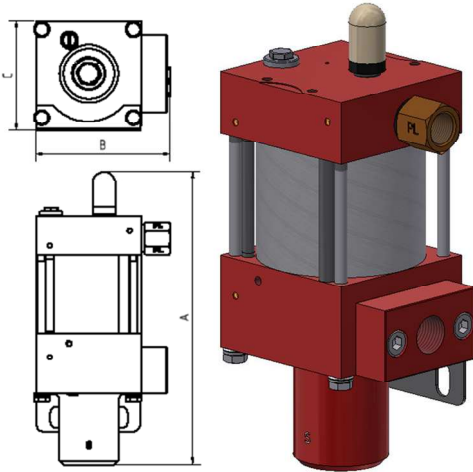

MO12
single acting, single air drive head
(Standard= Bottom inlet)

Technical Data:

Air drive pressure: 1 - 10 bar / 14.5 - 145 psi

Calculated working pressure: 140 bar / 2030 psi

Pressure ratio: 1:14

Displacement volume/double stroke: 9.4 cm³ / 0.57 cu.inch

Connections:

Inlet: Standard: Bottom Inlet 3/4" BSP

Outlet: 1/2" BSP

Air drive: 3/8" BSP

Maximum operating temperature: 60°C

Net weight: 2.5 kg

Pressure and flow performances, please see enclosed graph.

Wetted materials of construction:

Top cap: 3.1645

Air cylinder: 3.3206

Seal package: Polyurethane, NBR

Pump Body: 3.1645

Piston: 1.4112

Approximate Dimensions:

Height: 224 mm

Depth: 102 mm

Width: 84 mm

Available Options:

Special inlet and outlet ports, i.e. NPT: MO12-NPT

Special seal material to handle special fluids on request.

Available Accessories:

Air control units with filter pressure regulator, control pressure gauge and shut off valve: MO12 with C1

To protect the pump against excessive outlet pressures or to limit the outlet pressure, a safety valve can be fitted to the air control unit in the air drive line. MO12 with C1/SV-air (The required outlet pressure has to be indicated.)

Please consult factory for more information. All technical and dimensional information subject to change. All General Terms and Conditions of sale, including limitations of our liability, apply to all products and services sold.

Technical Data Sheet

MSF12(L)

» Special liquids

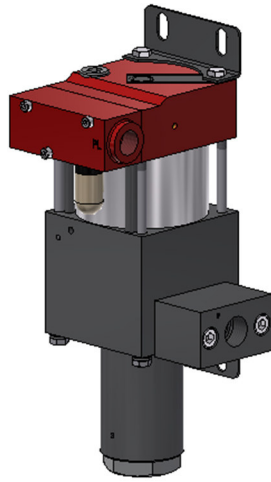
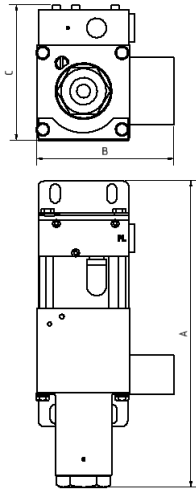

MSF12(L)
 single acting, single air drive head and
 distance piece
 (Standard= Bottom inlet)

Technical Data:

Air drive pressure:	1 - 10 bar / 14.5 - 145 psi
Calculated working pressure:	140 bar / 2030 psi
Pressure ratio:	1:14
Displacement volume/double stroke:	9.4 cm ³ / 0.57 cu.inch

Connections:

Inlet:	Standard: Bottom Inlet 3/4" BSP
Outlet:	1/2" BSP
Air drive:	3/8" BSP
Maximum operating temperature:	60°C
Net weight:	6.7 kg

Pressure and flow performances, please see enclosed graph.

Wetted materials of construction:

Seal package:	MSF12(L): PTFE
Pump Body:	1.4404
Piston:	1.4404
Fittings:	Inlet: 1.4305 Outlet: 1.4404

Approximate Dimensions:

A:	272 mm
B:	120 mm
C:	120 mm

Available Options:

Special inlet and outlet ports, i.e. NPT:	MSF12(L)-NPT
Special seal material to handle special fluids on request.	

Available Accessories:

Air control units with filter pressure regulator, control pressure gauge and shut off valve:	MSF12(L) with C1
To protect the pump against excessive outlet pressures or to limit the outlet pressure, a safety valve can be fitted to the air control unit in the air drive line.	MSF12 (L) with C1/SV-air (The required outlet pressure has to be indicated.)

Please consult factory for more information. All technical and dimensional information subject to change. All General Terms and Conditions of sale, including limitations of our liability, apply to all products and services sold.



Leistungsdiagramm/Performance Graph M(O)(SF) 12

Prüfflüssigkeit/Test Liquid: Wasser-Öl-Emulsion/Water Oil Emulsion ca. 1 - 10 cst

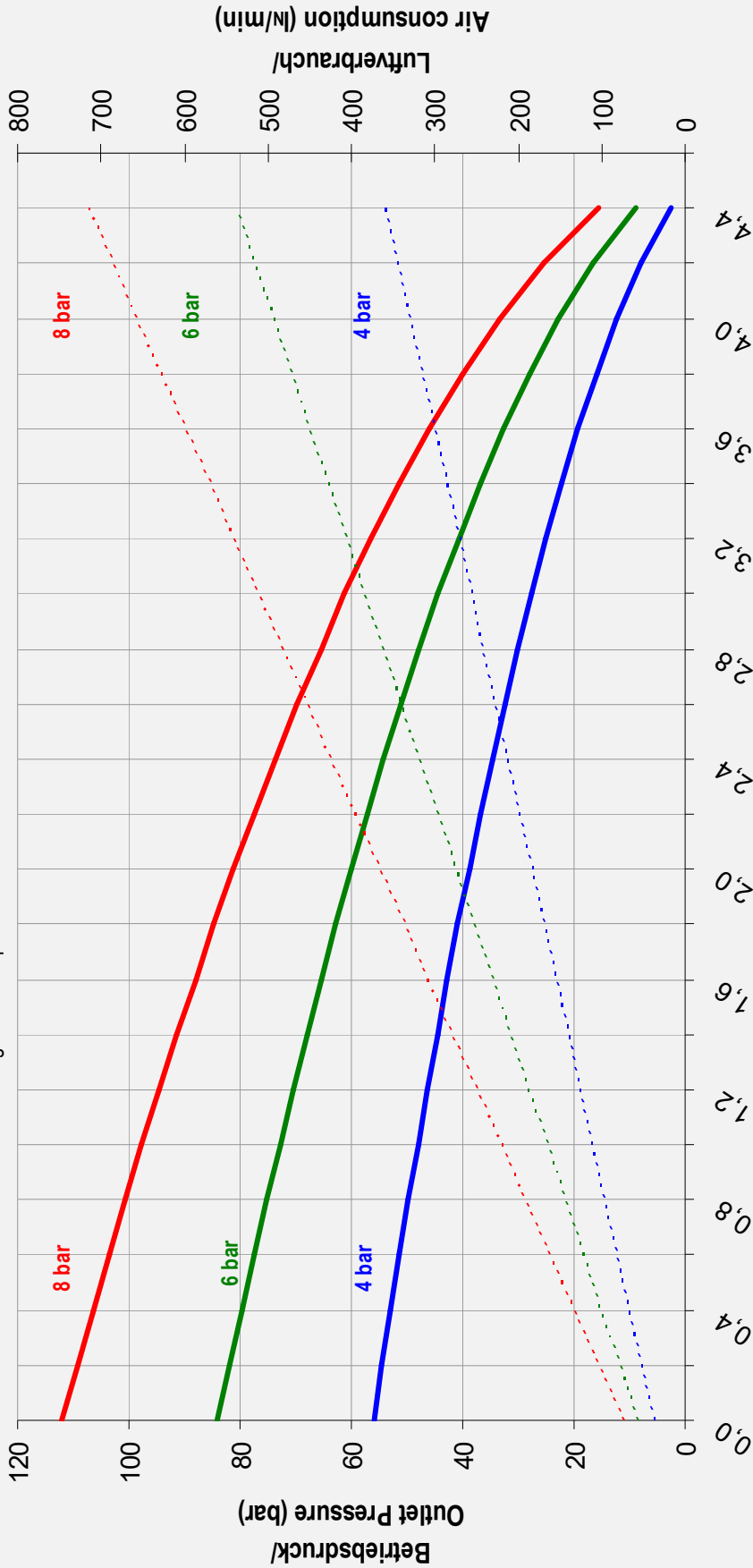

Förderleistung/Flow (l/min)

- Betriebsdruck bei/Outlet Pressure at 4 bar
- Betriebsdruck bei/Outlet Pressure at 8 bar
- Betriebsdruck bei/Outlet Pressure at 6 bar
- ⋯ Luftverbrauch bei/Air consumption at 4 bar
- ⋯ Luftverbrauch bei/Air consumption at 8 bar
- ⋯ Luftverbrauch bei/Air consumption at 6 bar